

UCFA 2 (normal-duty)

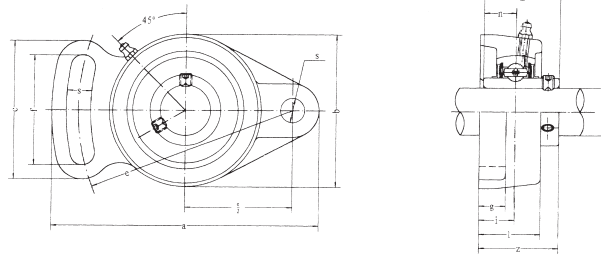

Unit No.	Dimensions <small>mm inch</small>													Bolt Size <small>mm inch</small>	Bearing No.	Housing No.	Weight (kg)
	d	a	e	i	q	l	s	b	z	f	c	B	n				
UCFA 201	12	98	78	15	12	25.5	10	60	33.3	40	50	31	12.7	M8	UC 201	FA204	0.50
UCFA 201-8	3/4														UC 201-8		0.49
UCFA 202	15														UC 202		0.49
UCFA 202-9	9/16														UC 202-9		0.49
UCFA 202-10	5/8	3-55/64	3-5/64	19/32	15/32	1	25/64	2-3/8	1-5/16	1-37/64	1-31/32	1.2205	0.500	5/16	UC 202-10		0.49
UCFA 203	17														UC 203		0.48
UCFA 203-11	11/16														UC 203-11		0.47
UCFA 204	20														UC 204		0.46
UCFA 204-12	3/4														UC 204-12		0.46
UCFA 205	25	124	98	16	14	27	13	70	35.8	51	65	34.1	14.3	M10	UC 205	FA205	0.66
UCFA 205-13	13/16														UC 205-13		0.70
UCFA 205-14	7/8	4-7/8	3-55/64	5/8	35/64	1-1/16	33/64	2-3/4	1-13/32	2-1/64	2-9/16	1.3425	0.563	3/8	UC 205-14		0.69
UCFA 205-15	15/16														UC 205-15		0.67
UCFA 205-16	1														UC 205-16		0.66
UCFA 206	30	141	115	18	14	31	13	83	40.2	58	72	38.1	15.9	M10	UC 206	FA206	0.93
UCFA 206-17	1-1/16														UC 206-17		0.96
UCFA 206-18	1-1/8	5-35/64	4-17/32	45/64	35/64	1-7/32	33/64	3-17/64	1-19/32	2-9/32	2-27/32	1.5000	0.626	3/8	UC 206-18		0.95
UCFA 206-19	1-3/16														UC 206-19		0.93
UCFA 206-20	1-1/4														UC 206-20		0.92
UCFA 207	35	155	128	19	16	34	15	96	44.4	66	82	42.9	17.5	M12	UC 207	FA207	1.46
UCFA 207-20	1-1/4														UC 207-20		1.52
UCFA 207-21	1-5/16	6-7/8	5-3/64	3/4	5/8	1-11/32	19/32	3-25/32	1-3/4	2-19/32	3-15/64	1.6890	0.689	7/16	UC 207-21		1.49
UCFA 207-22	1-3/8														UC 207-22		1.46
UCFA 207-23	1-7/16														UC 207-23		1.43
UCFA 208	40	171	142	21	16	38	15	105	51.2	71	87	49.2	19	M12	UC 208	FA208	1.78
UCFA 208-24	1-1/2	47/64	5-19/32	53/64	5/8	1-1/2	19/32	4-9/64	2-1/64	2-51/64	3-27/64	1.9370	0.748	7/16	UC 208-24		1.82
UCFA 208-25	1-9/16														UC 208-25		1.79
UCFA 209	45	179	146	22	18	40	17	111	52.2	72	90	49.2	19	M14	UC 209	FA209	2.03
UCFA 209-26	1-5/8														UC 209-26		2.13
UCFA 209-27	1-11/16	7-3/64	5-3/4	55/64	45/64	1-37/64	43/64	4-3/8	2-1/16	2-53/64	3-35/64	1.9370	0.748	1/2	UC 209-27		2.09
UCFA 209-28	1-3/4														UC 209-28		2.05
UCFA 210	50	189	155	22	18	40	17	116	54.6	76	94	51.6	19	M14	UC 210	FA210	2.23
UCFA 210-29	1-13/16														UC 210-29		2.35
UCFA 210-30	1-7/8	7-7/16	6-7/64	55/64	45/64	1-37/64	43/64	4-9/16	2-5/32	3	3-45/64	2.0315	0.748	1/2	UC 210-30		2.30
UCFA 210-31	1-15/16														UC 210-31		2.25
UCFA 210-32	2														UC 210-32		2.21
UCFA 211	55	216	182	25	20	44	17	133	58.4	86	104	55.6	22.2	M14	UC 211	FA211	3.41
UCFA 211-32	2														UC 211-32		3.56
UCFA 211-33	2-1/16	8-1/2	7-11/64	63/64	25/32	1-47/64	43/64	5-51/64	2-5/16	3-25/64	4-3/32	2.1890	0.874	1/2	UC 211-33		3.50
UCFA 211-34	2-1/8														UC 211-34		3.45
UCFA 211-35	2-3/16														UC 211-35		3.39
UCFA 212	60	240	202	29	20	48	19	140	68.7	100	118	65.1	25.4	M16	UC 212	FA212	4.29
UCFA 212-36	2-1/4														UC 212-36		4.42
UCFA 212-37	2-5/16	9-29/64	7-61/64	1-9/64	25/32	1-7/8	3/4	5-1/2	2-23/32	3-15/16	4-41/64	2.5630	1.000	5/8	UC 212-37		4.35
UCFA 212-38	2-3/8														UC 212-38		4.27
UCFA 212-39	2-7/16														UC 212-39		4.20
UCFA 213	65	250	210	30	20	50	19	155	69.7	102	122	65.1	25.4	M14	UC 213	FA213	5.21
UCFA 213-40	2-1/2	9-27/32	8-17/64	1-3/16	25/32	1-31/32	3/4	6-3/32	2-3/4	4-1/64	4-51/64	2.5630	1.000	5/8	UC 213-40		5.29
UCFA 213-41	2-9/16														UC 213-41		5.15